



Smart MDI system*
Because CGM alone is not enough

A smart step-by-step user guide



Medtronic
Engineering the extraordinary

Guardian™ 4 Smart CGM system
InPen™ Smart insulin pen system

*Components sold separately

Setting up the Smart MDI system

Ensure you have the following ready:

- A. Guardian™ 4 transmitter and charger
- B. Guardian™ 4 sensor
- C. One Press server
- D. Guardian™ 4 oval tape
- E. App installed & bluetooth enabled

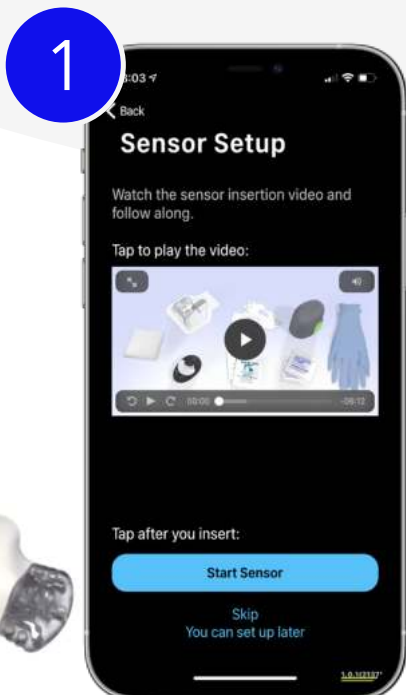

Setting up the Guardian™ 4 app

The Continuous Glucose Monitoring (CGM) system, sends glucose readings every 5 minutes, 24/7, giving you the reassurance to stay ahead of your glucose levels.^{1,2}

- Download the app and create a Carelink™ Personal account
- Follow the on-screen instructions to pair the sensor
- Insert the sensor (B) and set up the alerts



Download the Guardian™ app

2

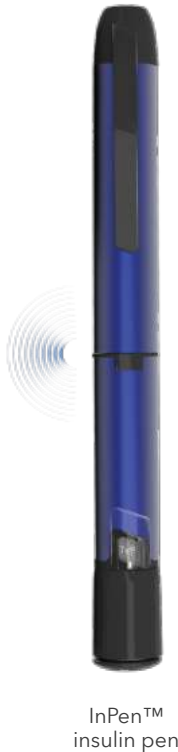
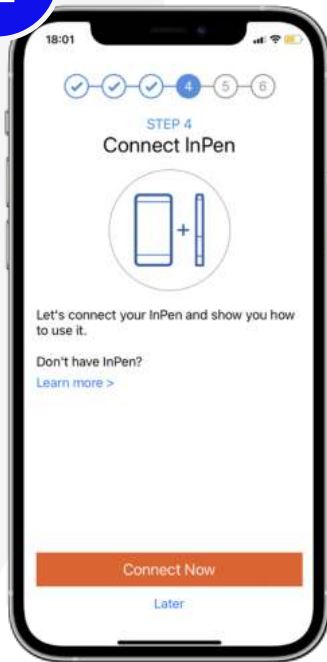
InPen™
insulin pen

Setting up the InPen™ app

Automatically† helps track insulin data, administer personalised insulin doses and lets you know if a dose is missed.

- People download the InPen™ app and create an InPen™ account
- Pair the InPen™ insulin pen to the app
- Follow the app tutorial in the app



Download the InPen™ app

Connecting the Guardian™ app with the InPen™ app

InPen™ system and Guardian™ 4 system are designed to work together.

- Connect the two apps together by following the final InPen™ app instructions
- You will be prompted to enter your CareLink™ Personal username and password
- The Guardian™ app sends the glucose data to the InPen™ system app so you have a one-stop, clear view
- Click on Settings in bottom right corner and then on Connections and add all available connections - Medtronic CGM and InPen™ Reports in CareLink™
- A Care Partner account can be set up for up to 5 care partners to be invited and be involved

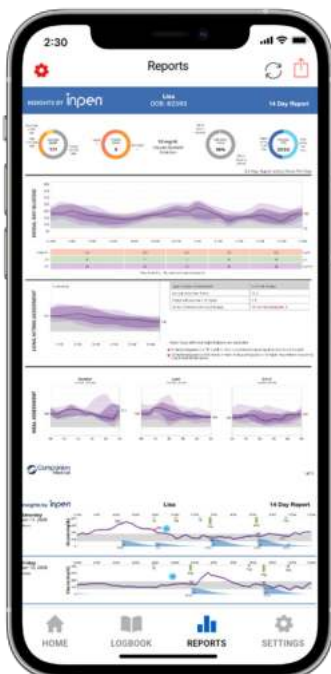

3

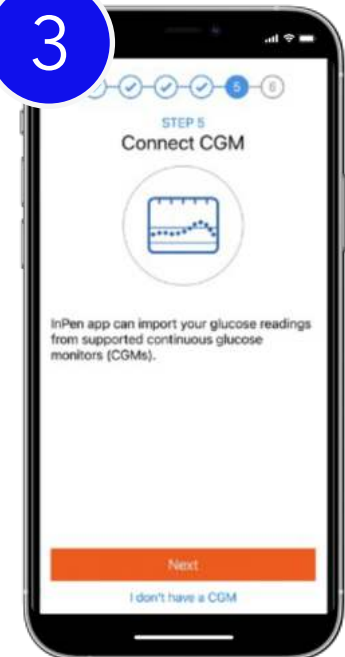

4

Start sharing reports

You can send you their InPen™ insight reports by email via the app.

You can also share your CareLink™ Personal user name with your healthcare team so they can receive automatic data uploads.

Reminders and notifications

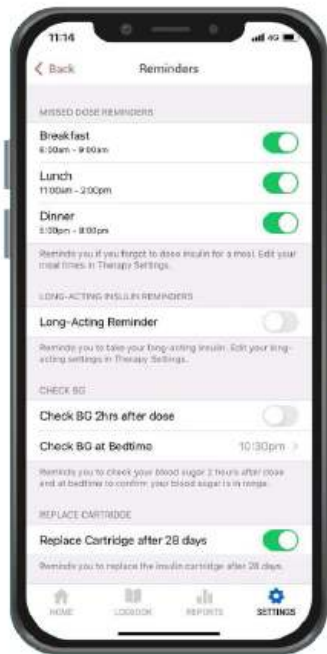

Missed dose

Long acting insulin

Check BG

Replace cartridge



Meal Dose Reminder: Dose Reminder is enabled, and no dose was taken during the time window.



Long-acting Reminder: Long-acting Reminder is enabled, and no Long-acting dose was logged at the reminder time.



Check BG Reminder: If enabled you will receive an alarm 2 hours after dose and at bedtime.



Insulin Age: Cartridge Replace Reminder is enabled, and the InPen™ app has not detected a new cartridge being installed within the past 28 days.



Low Battery: InPen™ is reaching the end of its 1-year life and needs to be replaced.



Temperature: InPen™ app detects a very high (above 37°C) or very low (below 0°C) temperature and user may want to consider replacing the insulin cartridge.

Reminders can help you keep on track with your diabetes management plan.

† Some user interaction required.

References:

1. Abraham SB, et al. Improved Real-World Glycaemic Control With Continuous Glucose Monitoring System Predictive Alerts. *Journal of Diabetes Science and Technology* 2021; 15(1):91-97.
2. Smith M, et al. E5, SIPs Improve Time Below Range in MDI Therapy, AMCP Congress 2020.

Medtronic

Medtronic Australasia Pty Ltd
2 Alma Road Macquarie Park, NSW 2113 Australia.
Website: medtronic-diabetes.com.au

Tel: +61 2 9857 9000
Fax: +61 2 9889 5167
Toll Free: 1 800 777 808

Email: australia.diabetes@medtronic.com
Facebook: www.facebook.com/MedtronicDiabetesAUS
YouTube: Medtronic Diabetes ANZ

This material does not replace or supersede the instructions for use. It should not be considered the exclusive source of information, and should be used in conjunction with the User Guide. See the User Guide for a detailed list of information regarding the instructions for use, indications, contraindications, warnings, precautions, and potential adverse events.

For further information, contact your local Medtronic representative and/or consult the Medtronic website at medtronic.diabetes.com.au

12987-082023 © Medtronic 2023. All rights reserved. Medtronic and the Medtronic logo are trademarks of Medtronic™

* Third party brands are trademarks of their respective owners. All other brands are trademarks of a Medtronic company.