

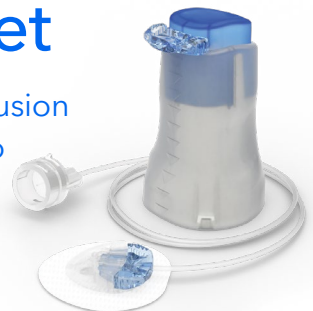

Isabelle
MiniMed™ Champion

Extended™ Infusion Set

The only available infusion set which allows up to 7-days of wear.**



An innovative design which allows up to 7-days of wear**

Tubing and connector innovation

- Reduced risk of occlusion¹
- Reduced risk of hyperglycaemia¹
- Stable insulin absorption¹
- Better maintenance of insulin stability²

Skin-friendly adhesive patch³

- Provides comfort and durability
- Less risk of irritation

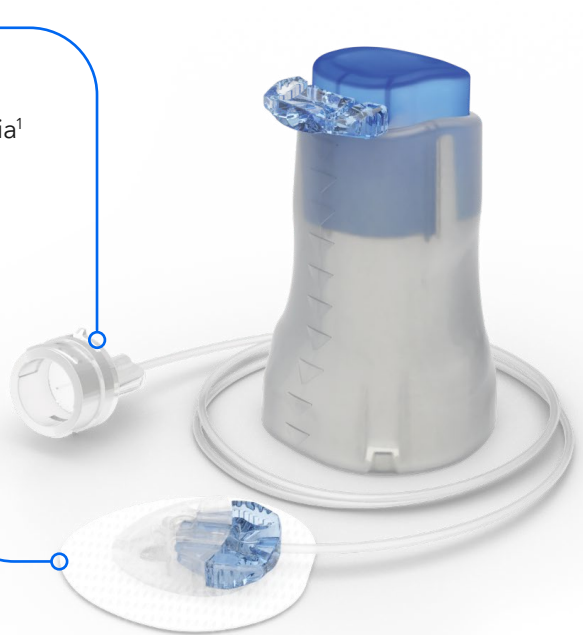

Extended™ reservoir

Reduce insulin wastage

Extended™ reservoir, allowing a reservoir only change when needed.

Available in 3.0ml only.





Reduce your set changes by half**

Giving your infusion sites more time to rest.**



Simple to insert⁴

With one-handed insertion, the Extended™ infusion set is even easier to place in hard-to-reach areas of the body.⁴



Reduce plastic waste⁵

By using Extended™ and changing your infusion set less often, you can reduce plastic waste by half which is equivalent to up to 1.9kg a year.⁵

No more 3-day routine in a 7-day world.**

Current MiniMed™ infusion sets are changed
every 2 to 3 days

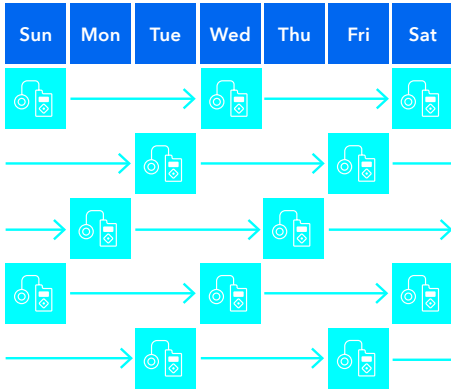

Extended™ infusion set up to 7 days wear.**
Reduce your set changes by half**

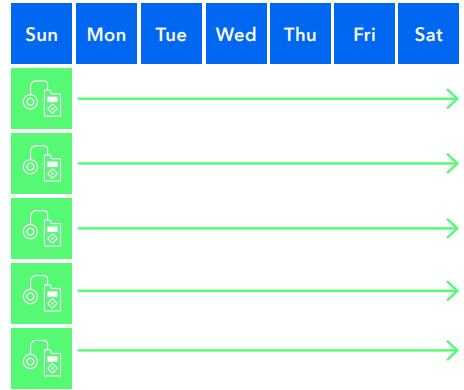

“Once a week Isabelle
changes her infusion set,
it’s that easy.”

- Jade, Mum of MiniMed™ Champion Isabelle.



ALWAYS FOLLOW THE DIRECTIONS FOR USE.

Information contained here is not medical advice and should not be used as an alternative to speaking with your doctor. Discuss indications, contraindications, warnings, precautions, potential adverse events and any further information with your healthcare professional.

IMPORTANT SAFETY INFORMATION

Infusion sets are indicated for the subcutaneous infusion of medication, including insulin, from infusion pumps. See the device manual for detailed information regarding the instructions for use, indications, contraindications, warnings, precautions, and potential adverse events. For further information, contact your local MiniMed™ representative.

References 1. Ilany J, et al. Abstract 416 - Clinical study of a new Extended™ wear infusion set design. 13th ATTD International Conference, February 2020. 2. Zhang JY, et al. Advances in Insulin Pump Infusion Sets Symposium Report. J Diabetes Sci Technol. 2021;15(3):705-709. 3. Zhang G, et al. 986-P - Assessment of adhesive patches for an Extended™ wear infusion set. 80th ADA International Conference, June 2020. 4. Medtronic Data on File. Minimed™ Mio™ Advance US Pivotal Trials. 152 Patients interviewed. 2020. 5. Fusselman H, et al. FUSS2015D-P - The Extended™ Wear Infusion Set - A Design for Plastic Waste Reduction. Virtual Diabetes Technology Meeting, 2020. **vs the 3-days infusion set MiniMed™ Quick-set™.

Medtronic Australasia Pty Ltd. Level 8, 11 Khartoum Road, Macquarie Park, NSW 2113 Australia. Tel: +61 2 9857 9000, Toll Free: 1800 777 808. Email: australia.diabetes@medtronic.com. Approval 14163-042024. ©2026 Medtronic MiniMed Inc. MiniMed and MiniMed logo are trademarks of Medtronic MiniMed, Inc.™™ Third-party brands are trademarks of their respective owners. All other brands are trademarks of a MiniMed company.

